

SERVICE MANUAL

COMPACT DISC
STEREO SYSTEM

BASIC TAPE MECHANISM : 2ZM-1 R14NM
BASIC CD MECHANISM : TN-CCD1001-902M

SYSTEM	SPEAKER	REMOTE CONTROLLER
XR-MS3	SX-M7	RC-ATT03(B)

- This Service Manual is the "Supplement" and replaces "Simple Manual" XR-MS3 (HR), (S/M Code No. 09-008-422-6T4).
- This Service Manual contains information about the difference between XR-MS3 (HR) and XR-MS3 (HC). If requiring the other information, see Service Manual of XR-MS3 (HC), (S/M Code No. 09-008-422-6R2).

SPECIFICATIONS

FM tuner section

Tuning range	87.5 MHz to 108 MHz
Usable sensitivity (IHF)	13.2 dBf
Antenna terminals	75 ohms (unbalanced)

AM tuner section

Tuning range	530 kHz to 1710 kHz (10 kHz step) 531 kHz to 1602 kHz (9 kHz step)
Usable sensitivity	350 μ V/m
Antenna	Loop antenna

Amplifier section

Power output	Rated : 12 W + 12 W (50 Hz to 20 kHz, T.H.D. less than 1%, 6 ohms) Reference : 15 W + 15 W (1 kHz, T.H.D. 10 %, 6 ohms) 0.15% (6 W, 1kHz, 6 ohms, DIN AUDIO)
Total harmonic distortion	
Input	VIDEO / AUX: 600 mV
Outputs	SPEAKERS: accept speakers of 6 ohms or more PHONES (stereo mini jack): accepts headphones of 16 ohms or more SUPER WOOFER: 0.8 V DIGITAL OUT (OPTICAL) jack

Compact disc player section

Laser	Semiconductor laser ($\lambda = 780$ nm)
D-A converter	1 bit dual
Signal-to-noise ratio	85 dB (1 kHz, 0 dB)
Harmonic distortion	0.05 % (1 kHz, 0 dB)
Wow and flutter	Unmeasurable

Cassette deck section

Track format	4 tracks, 2 channels stereo
Frequency response	CrO ₂ tape : 50 Hz – 16000 Hz Normal tape : 50 Hz – 15000 Hz
Signal-to-noise ratio	60 dB (Dolby B NR ON, CrO ₂ tape peak level)
Recording system	AC bias
Heads	Recording / Playback head x 1, erase head x 1

General

Power requirements	120 V / 220-240 V AC switchable 50 / 60 Hz
Power consumption	75 W
Standby power consumption	1.9 W (power-economizing mode set to ON)
Dimensions of main unit (W x H x D)	100 x 210.6 x 271.5 mm
Weight of main unit	3.8 kg

Speaker system

Cabinet type	2 way, bass reflex (magnetic shielded type)
Speakers	Woofer : 85 mm Tweeter: 22 mm dome type
Impedance	6 ohms
Output sound pressure level	86 dB/W/m
Dimensions (W x H x D)	100 x 206 x 188 mm
Weight	1.5 kg

• Design and specifications are subject to change without notice.

• The word "BBE" and the "BBE symbol" are trademarks of BBE Sound, Inc.
Under license from BBE Sound, Inc.

• Dolby noise reduction manufactured under license from Dolby Laboratories Licensing Corporation.
"DOLBY" and the double-D symbol  are trademarks of Dolby Laboratories Licensing Corporation.

ELECTRICAL MAIN PARTS LIST

REF. NO.	PART NO.	KANRI NO.	DESCRIPTION	REF. NO.	PART NO.	KANRI NO.	DESCRIPTION
IC				C8	87-010-196-080		CHIP CAPACITOR,0.1-25
	8A-CJ5-601-010		C-IC,LC876580W-5N98	C9	87-A12-033-090		CAP,E 6800-25 SMG30L
	87-070-246-010		IC,GPIU271X	C10	87-010-409-080		CAP,E 220-50 SME
	87-A20-909-010		IC,LA4663	C11	87-010-380-080		CAP, ELECT 47-16V
	87-017-915-080		IC,BU4094BCF	C13	87-010-408-080		CAP, ELECT 47-50V
	87-017-585-080		IC,NJM4580E				
	87-A20-355-010		IC,CXA1553P	C14	87-010-235-080		CAP,E 470-16 SME
	87-A20-783-040		C-IC,BA7762AFS	C15	87-010-387-080		CAP,E 470-25 SME
	87-A21-022-040		C-IC,BA3880FS	C16	87-012-369-080		C-CAP,S 0.047-50F
	87-A21-103-040		C-IC,MM1454XFBE	C17	87-012-369-080		C-CAP,S 0.047-50F
	87-A21-111-040		C-IC,M62495FP	C18	87-A10-776-080		CAP,E 1000-25 M 105 KMG
	87-017-825-010		IC,GPIF32T	C19	87-010-403-080		CAP, ELECT 3.3-50V
	87-020-454-010		IC,DN6851	C30	87-010-112-080		CAP, ELECT 100-16V
	87-070-127-110		IC,LC72131D	C31	87-016-126-080		CAP,E 470-16 M 105 KME
	87-A20-913-010		IC,LA1837NL	C61	87-010-260-080		CAP, ELECT 47-25V
TRANSISTOR				C62	87-010-496-040		CAP,E 3.3-50 GAS
	89-213-702-010		TR,2SB1370E	C91	87-010-401-080		CAP, ELECT 1-50V
	87-A30-076-080		C-TR,2SC3052F	C92	87-010-260-080		CAP, ELECT 47-25 M 11L SME
	87-026-610-080		TR,KTC3198GR	C101	87-010-754-080		CAP,E220-10 SRA 7L
	87-A30-075-080		C-TR,2SA1235F	C102	87-A10-189-040		CAP,E220-10 M 5L
	87-A30-234-080		TR,CSC4115BC	C103	87-010-196-080		CHIP CAPACITOR,0.1-25
	89-418-580-080		TR,2SD1858TV2	C104	87-010-198-080		CAP, CHIP 0.022
	87-026-245-080		TR,DTC114ES	C105	87-010-196-080		CHIP CAPACITOR,0.1-25
	87-A30-198-080		TR,KTC3199GR	C106	87-010-400-040		CAP,E 0.47-50
	87-026-609-080		TR,KTA1266GR	C108	87-010-313-080		CAP, CHIP 18P
	87-026-210-080		CHIP-TR,DTC144EK	C109	87-012-156-080		C-CAP,S 220P-50 CH
	87-A30-087-080		C-FET,2SK2158				
	87-A30-073-080		C-TR,RT1N 141C	C110	87-010-196-080		CHIP CAPACITOR,0.1-25
	87-026-236-080		C-TR,DTC124EK	C111	87-010-079-040		CAP,E 100-6.3 5L
	87-A30-086-070		C-TR,CSD1306E	C112	87-010-194-080		CAP, CHIP 0.047
	87-026-211-080		C-TR,DTA144EK	C114	87-010-194-080		CAP, CHIP 0.047
	87-A30-240-080		TR,CSA1585BC	C115	87-010-405-040		CAP,E 10-50
	87-A30-159-080		C-TR,KTA1298Y				
	87-A30-072-080		C-TR,RT1P 144C	C116	87-010-196-080		CHIP CAPACITOR,0.1-25
	87-A30-273-040		C-TR,DTC124EKA	C117	87-010-196-080		CHIP CAPACITOR,0.1-25
	87-A30-105-080		C-TR,RT1P441C	C118	87-010-196-080		CHIP CAPACITOR,0.1-25
	89-327-143-080		C-TR,2SC2714 (0.1W)	C129	87-010-316-080		C-CAP,S 33P-50 CH
				C130	87-010-178-080		CHIP CAP 1000P
DIODE				C201	87-010-491-040		CAP,E 0.22-50 GAS
	87-020-465-080		DIODE,1SS133	C202	87-010-545-040		CAP,E 0.22-50 SME
	87-A40-224-010		DIODE,GBU8DL	C203	87-010-178-080		CHIP CAP 1000P-50 KB
	87-A40-313-080		C-DIODE,MC 2840	C204	87-010-178-080		CHIP CAP 1000P-50 KB
	87-A40-346-080		ZENER,MTZJ 8.2C	C205	87-010-546-040		CAP,E 0.33-50
	87-A40-345-080		ZENER,MTZJ10C				
	87-070-274-080		DIODE,1N4003 SEM	C206	87-010-546-040		CAP,E 0.33-50
	87-A40-336-080		ZENER,MTZJ27D T-72	C211	87-010-405-040		CAP,E 10-50
	87-A40-435-080		ZENER,MTZJ30D	C212	87-010-260-080		CAP, ELECT 47-25V
	87-A40-270-080		C-DIODE,MC2838	C215	87-010-405-080		CAP, ELECT 10-50V
	87-A40-004-080		ZENER,MTZJ16A	C216	87-010-405-080		CAP, ELECT 10-50V
	87-070-136-080		ZENER,MTZJ5.1B				
	87-A40-509-080		ZENER,MTZJ6.8C	C217	87-012-368-080		C-CAP,S 0.1-50 F
	87-A40-269-080		C-DIODE,MC2836	C218	87-012-368-080		C-CAP,S 0.1-50 F
	87-A40-235-080		ZENER,MTZJ9.1C	C219	87-012-368-080		C-CAP,S 0.1-50 F
	87-A40-293-080		ZENER,DZ2.7M	C220	87-012-368-080		C-CAP,S 0.1-50 F
	87-A40-438-080		ZENER,MTZJ4.7A	C221	87-010-405-080		CAP, ELECT 10-50V
	87-017-149-080		ZENER,HZS6A2L				
MAIN C.B				C223	87-010-196-080		C-CAP,S 0.1-25 ZF
C1	87-010-194-080		CAP, CHIP 0.047	C227	87-012-153-080		C-CAP,S 120P-50 J CH GRM
C2	87-010-194-080		CAP, CHIP 0.047	C228	87-012-153-080		C-CAP,S 120P-50 J CH GRM
C3	87-010-196-080		CHIP CAPACITOR,0.1-25	C230	87-010-196-080		C-CAP,S 0.1-25 ZF
C4	87-010-196-080		CHIP CAPACITOR,0.1-25	C301	87-010-322-080		C-CAP,S 100P-50 CH
C5	87-010-196-080		CHIP CAPACITOR,0.1-25				
C6	87-010-196-080		CHIP CAPACITOR,0.1-25	C302	87-010-322-080		C-CAP,S 100P-50 CH
C7	87-010-194-080		CAP, CHIP 0.047	C303	87-016-044-040		CAP,E 100-16 GAS
				C304	87-016-044-040		CAP,E 100-16 GAS
				C305	87-010-071-040		CAP,E 1-50 M 5L SRE
				C306	87-010-071-040		CAP,E 1-50 M 5L SRE
				C307	87-010-553-040		CAP,E 47-16 GAS
				C308	87-010-555-040		CAP,E 100-10 GAS
				C311	87-010-178-080		C-CAP,S 1000P-50 KB
				C312	87-010-197-080		C-CAP,S 0.01-25 KB
				C401	87-010-196-080		CHIP CAPACITOR,0.1-25
				C402	87-010-260-080		CAP, ELECT 47-25V
				C403	87-010-404-080		CAP, ELECT 4.7-50V
				C404	87-010-404-080		CAP, ELECT 4.7-50V
				C405	87-010-404-080		CAP, ELECT 4.7-50V
				C406	87-010-404-080		CAP, ELECT 4.7-50V

REF.NO.	PART NO.	KANRI NO.	DESCRIPTION
C407	87-010-188-080	CAP,CHIP 6800P	
C408	87-010-188-080	CAP,CHIP 6800P	
C409	87-012-140-080	CAP 470P	
C410	87-012-140-080	CAP 470P	
C411	87-010-404-080	CAP, ELECT 4.7-50V	
C412	87-010-404-080	CAP, ELECT 4.7-50V	
C413	87-010-404-080	CAP, ELECT 4.7-50V	
C414	87-010-404-080	CAP, ELECT 4.7-50V	
C415	87-010-197-080	CAP, CHIP 0.01 DM	
C416	87-010-197-080	CAP, CHIP 0.01 DM	
C417	87-010-195-080	C-CAP,S 0.068-25 F	
C418	87-010-195-080	C-CAP,S 0.068-25 F	
C419	87-010-260-080	CAP, ELECT 47-25V	
C421	87-012-140-080	CAP 470P	
C422	87-012-140-080	CAP 470P	
C552	87-010-112-080	CAP, ELECT 100-16V	
C553	87-010-260-080	CAP, ELECT 47-25V	
C554	87-010-197-080	CAP, CHIP 0.01 DM	
C555	87-010-197-080	CAP, CHIP 0.01 DM	
C557	87-010-405-080	CAP, ELECT 10-50V	
C573	87-010-405-080	CAP, ELECT 10-50V	
C574	87-010-405-080	CAP, ELECT 10-50V	
C575	87-010-322-080	C-CAP,S 100P-50 CH	
C601	87-010-187-080	CAP CHIP S5600P	
C602	87-010-187-080	CAP CHIP S5600P	
C605	87-010-182-080	C-CAP,S 2200P-50 B	
C606	87-010-182-080	C-CAP,S 2200P-50 B	
C607	87-010-213-080	C-CAP,S 0.015-50 B	
C608	87-010-213-080	C-CAP,S 0.015-50 B	
C609	87-010-545-080	CAP, ELECT 0.22-50V	
C610	87-010-491-080	CAP,E 0.22-50 GAS	
C611	87-010-545-080	CAP, ELECT 0.22-50V	
C612	87-010-491-080	CAP,E 0.22-50 GAS	
C613	87-010-553-080	CAP,E 47-16	
C614	87-010-553-080	CAP,E 47-16	
C615	87-010-154-080	CAP CHIP 10P	
C622	87-010-402-080	CAP, ELECT 2.2-50V	
C623	87-010-402-080	CAP, ELECT 2.2-50V	
C641	87-010-196-080	CHIP CAPACITOR,0.1-25	
C643	87-010-805-080	CAP, S 1-16	
C644	87-010-196-080	CHIP CAPACITOR,0.1-25	
C661	87-010-175-080	C-CAP,S 560P-50 J SL	
C662	87-010-175-080	C-CAP,S 560P-50 J SL	
C677	87-010-197-080	C-CAP,S 0.01-25 KB	
C702	87-018-209-080	CAP,TU U 0.1-50 ZF	
C703	87-010-197-080	CAP, CHIP 0.01 DM	
C704	87-010-382-040	CAP,E 22-25 SME	
C706	87-010-382-040	CAP,E 22-25 SME	
C902	87-012-156-080	C-CAP,S 220P-50 J CH	
C903	87-010-322-080	C-CAP,S 100P-50 CH	
CN1	87-A60-850-010	CONN,7P V VH	
CN91	87-A60-619-010	CONN,2P V 2MM JMT	
CN601	87-A60-902-010	CONN,14P V BLK FMN-BTRK	
CN701	87-A60-619-010	CONN,2P V 2MM JMT	
CN901	87-A60-770-010	CONN,18P B TMC-D(X)	
CN902	87-A60-900-010	CONN,9P V BLK FMN-BTRK	
CN904	87-099-570-010	CONN,13P TUC-P13P-B1	
CN905	87-A61-258-010	CONN,15P V 52806-1510	
CNA002	88-805-040-820	CONN ASSY,4P 80	
CNA003	88-805-051-420	CONN ASSY,5P 140	
CNA201	88-805-043-020	CONN ASSY,4P 300	
CNA700	8A-CJ5-634-010	CONN ASSY,2P SHLD	
FC905	8A-CL5-632-010	CABLE,FPC15P-1.0 165	
J201	87-A60-238-010	TERMINAL,SP 4P (MSC)	
J202	87-099-801-010	JACK,PIN 1P BLK	
J601	87-A60-881-010	JACK,PIN 2P MSP 242V05 PBSN	
JR603	87-A50-190-080	C-COIL,S BLM21A102S	
L101	87-A50-333-010	COIL,OSC 9.43MHZ	
PR2	87-026-689-080	PROTECTOR,1A 60V 491	
PR3	87-A90-195-080	PROTECTOR 7A 125V 49	



REF.NO.	PART NO.	KANRI NO.	DESCRIPTION
PR4	87-A90-195-080		PROTECTOR 7A 125V 49
PR5	87-026-689-080		PROTECTOR,1A 60V 491
WH005	87-A90-507-010		HLDR,WIRE 2.5-4P
FRONT C.B			
C102	87-010-415-040		CAP,E 10-50 5L
C103	87-012-157-080		C-CAP,S 330P-50 CH
C104	87-010-421-040		CAP,E 4.7-50 5L
C105	87-010-421-040		CAP,E 4.7-50 5L
C106	87-010-408-040		CAP,E 47-50 SME
C107	87-012-369-080		C-CAP,S 0.047-50F
C108	87-010-197-080		CAP, CHIP 0.01 DM
C109	87-010-197-080		CAP, CHIP 0.01 DM
C110	87-010-196-080		CHIP CAPACITOR,0.1-25
C111	87-012-368-080		C-CAP,S 0.1-50 F
C200	87-018-123-080		CAP,TC U 220P-50
C301	87-010-196-080		CHIP CAPACITOR,0.1-25
CN101	87-A60-778-010		CONN,18P B TMC-D(P)
FL101	8A-CL5-608-010		FL,9-ST-19GONK
LED101	87-A40-317-080		LED,SLR-342VCT31 RED
LED301	87-A40-786-080		LED,SMLS1BE16WTP4 BLU/UMB
LED302	87-A40-786-080		LED,SMLS1BE16WTP4 BLU/UMB
LED303	87-A40-786-080		LED,SMLS1BE16WTP4 BLU/UMB
R102	87-022-355-080		C-RES,S10K-1/10W F
R103	87-022-355-080		C-RES,S10K-1/10W F
S102	87-A91-743-010		SW,JOG 3-2-1 RE01311PCE2
S201	87-A90-095-080		SW,TACT EVQ11G04M
S202	87-A90-095-080		SW,TACT EVQ11G04M
S203	87-A90-095-080		SW,TACT EVQ11G04M
S204	87-A90-095-080		SW,TACT EVQ11G04M
S205	87-A90-095-080		SW,TACT EVQ11G04M
S206	87-A90-095-080		SW,TACT EVQ11G04M
S207	87-A90-095-080		SW,TACT EVQ11G04M
S208	87-A90-095-080		SW,TACT EVQ11G04M
S209	87-A90-095-080		SW,TACT EVQ11G04M
S210	87-A90-095-080		SW,TACT EVQ11G04M
S211	87-A90-095-080		SW,TACT EVQ11G04M
S212	87-A90-095-080		SW,TACT EVQ11G04M
S213	87-A90-095-080		SW,TACT EVQ11G04M
S214	87-A90-095-080		SW,TACT EVQ11G04M
S215	87-A90-095-080		SW,TACT EVQ11G04M
S216	87-A90-095-080		SW,TACT EVQ11G04M
TAPE C.B			
C303	87-012-157-080		C-CAP,S 330P-50 CH
C304	87-012-157-080		C-CAP,S 330P-50 CH
C307	87-010-196-080		CHIP CAPACITOR,0.1-25
C311	87-010-198-080		CAP, CHIP 0.022
C312	87-010-198-080		CAP, CHIP 0.022
C315	87-012-278-080		CHIP CAP,U 2200P-50B
C316	87-012-278-080		CHIP CAP,U 2200P-50B
C317	87-A10-201-080		C-CAP,S0.33-16 KB
C318	87-A10-201-080		C-CAP,S0.33-16 KB
C319	87-012-141-080		CHIP-CAPACITOR,0.22-16F
C320	87-012-141-080		CHIP-CAPACITOR,0.22-16F
C321	87-A10-025-080		C-CAP,U 0.22-16Z F
C322	87-A10-025-080		C-CAP,U 0.22-16Z F
C324	87-010-260-040		CAP,E 47-25 SME
C325	87-010-370-040		CAP,E 330-6.3 SME
C327	87-010-404-040		CAP,E 4.7-50 SME
C328	87-010-404-040		CAP,E 4.7-50 SME
C332	87-010-196-080		CHIP CAPACITOR,0.1-25
C335	87-010-401-040		CAP,E 1-50 SME
C336	87-010-401-040		CAP,E 1-50 SME
C337	87-010-196-080		CHIP CAPACITOR,0.1-25
C339	87-010-831-080		C-CAP,U,0.1-16F
C340	87-010-196-080		CHIP CAPACITOR,0.1-25
C351	87-012-140-080		CAP 470P



REF. NO.	PART NO.	KANRI NO.	DESCRIPTION	REF. NO.	PART NO.	KANRI NO.	DESCRIPTION
C352	87-012-140-080		CAP 470P	C714	87-012-286-020		CAP,U 0.01-25
C354	87-010-175-080		CAP 560P	C717	87-012-286-020		CAP,U 0.01-25
C355	87-010-178-080		CHIP CAP 1000P	C719	87-012-286-020		CAP,U 0.01-25
C356	87-010-260-040		CAP,E 47-25 SME	C720	87-012-195-020		C-CAP,U 100P-50CH
C357	87-010-197-080		CAP, CHIP 0.01 DM	C721	87-012-176-020		CAP,15P
C358	87-010-183-080		C-CAP,S 2700P-50 B	C722	87-012-176-020		CAP,15P
C359	87-010-183-080		C-CAP,S 2700P-50 B	C723	87-012-274-020		CHIP CAP,U 1000P-50B
C360	87-010-183-080		C-CAP,S 2700P-50 B	C725	87-012-274-020		CHIP CAP,U 1000P-50B
C370	87-010-196-080		CHIP CAPACITOR,0.1-25	C727	87-010-196-020		CHIP CAPACITOR,0.1-25
C371	87-010-177-080		C-CAP,S 820P-50 SL	C728	87-010-248-080		CAP,ELECT 220-10V
C372	87-010-177-080		C-CAP,S 820P-50 SL	C729	87-012-274-020		CHIP CAP,U 1000P-50B
C373	87-010-179-080		CAP,CHIP S B1200P	C731	87-012-286-020		CAP,U 0.01-25
C374	87-010-179-080		CAP,CHIP S B1200P	C733	87-010-987-080		C-CAP,S 1500P-50 CH
C375	87-010-545-040		CAP,E 0.22-50 SME	C734	87-010-987-080		C-CAP,S 1500P-50 CH
C376	87-010-545-040		CAP,E 0.22-50 SME	C735	87-010-987-080		C-CAP,S 1500P-50 CH
C378	87-010-196-080		CHIP CAPACITOR,0.1-25	C736	87-010-987-080		C-CAP,S 1500P-50 CH
C386	87-010-759-080		C-CAP,U, 0.1-25F	C737	87-A10-592-020		C-CAP,S 0.015-50 J B
C388	87-012-266-080		C-CAP,U 220P-50 B	C738	87-A10-592-020		C-CAP,S 0.015-50 J B
CN251	87-A60-626-010		CONN,9P V 2MM JMT	C751	87-012-365-020		C-CAP,S 0.027-25VBK
CN351	87-A60-625-010		CONN,8P V 2MM JMT	C752	87-012-365-020		C-CAP,S 0.027-25VBK
CN601	87-A60-891-080		C-CONN,14P V FMN-BMTTN-TF	C756	87-012-286-020		CAP,U 0.01-25
CN902	87-A60-888-080		C-CONN,9P V FMN-BMTTN-TF	C757	87-012-188-020		C-CAP,U 47P-50 CH
FC601	8A-CL5-628-010		CABLE,FPC14P-1.0 160	C758	87-012-167-020		C-CAP,U 5P-50 CH
FC902	8A-CL5-627-010		CABLE,FRCP-1.0 220	C763	87-010-829-020		CAP,U 0.047-16
L301	87-A50-049-010		COIL,TRAP 85K(COI)	C764	87-012-337-020		C-CAP,U 56P-50 CH
L302	87-A50-049-010		COIL,TRAP 85K(COI)	C765	87-012-286-020		CAP,U 0.01-25
L351	87-007-342-010		COIL,OSC 85K BIAS	C768	87-012-286-020		CAP,U 0.01-25
SFR303	87-024-435-080		SFR 33K RH 063EC	C769	87-010-260-080		CAP,ELECT 47-25V
SFR304	87-024-435-080		SFR 33K RH 063EC	C770	87-010-829-020		CAP,U 0.047-16
SFR305	87-A90-433-080		SFR,50K H NVZ6TLTA	C771	87-010-383-080		CAP,ELECT 33-25V
SFR306	87-A90-433-080		SFR,50K H NVZ6TLTA	C772	87-010-829-020		CAP,U 0.047-16
SFR351	87-A90-433-080		SFR,50K H NVZ6TLTA	C773	87-010-196-020		CHIP CAPACITOR,0.1-25
SFR352	87-A90-433-080		SFR,50K H NVZ6TLTA	C774	87-010-263-080		CAP,ELECT 100-10V
				C775	87-010-404-080		CAP,ELECT 4.7-50V
				C776	87-012-286-020		CAP,U 0.01-25
VM C.B				C777	87-010-400-080		CAP,ELECT 0.47-50V
C27	87-012-140-080		CAP 470P	C778	87-010-401-080		CAP,ELECT 1-50V
C29	87-010-247-080		CAP, ELECT 100-50V	C779	87-010-401-080		CAP,ELECT 1-50V
CN3	87-009-033-010		CONNECTOR, 5P	C780	87-010-196-020		CHIP CAPACITOR,0.1-25
CN5	87-A90-507-010		HLDR,WIRE 2.5-4P	C781	87-010-405-080		CAP,ELECT 10-50V
HP-JACK C.B				C782	87-010-405-080		CAP,ELECT 10-50V
C201	87-010-194-080		C-CAP,S 0.047-25 ZF	C783	87-012-286-020		CAP,U 0.01-25
C202	87-010-194-080		C-CAP,S 0.047-25 ZF	C784	87-012-286-020		CAP,U 0.01-25
CN102	87-A60-668-010		CONN,4P H 2MM JMT	C785	87-010-401-080		CAP,ELECT 1-50V
J101	87-A60-420-010		JACK,3.5 ST (MSC)	C786	87-010-401-080		CAP,ELECT 1-50V
AC C.B				C789	87-012-275-020		C-CAP,U 1200P-50 B
△ C1	87-A10-479-080		CAP,CER 2200P-250 M E KH	C790	87-012-275-020		C-CAP,U 1200P-50 B
△ CN1	87-A60-851-010		CONN,9P V VH	C791	87-010-405-080		CAP,ELECT 10-50V
△ CN2	87-A60-621-010		CONN,4P V 2MM JMT	C793	87-012-273-020		C-CAP,U 820P-50 B
△ PT1	8Z-NF8-663-010		PT,SUB ZNF-8 (H)	C794	87-010-406-080		CAP,ELECT 22-50
△ PT2	8A-CJ5-624-010		PT,ACJ-5 HE	C795	87-010-596-020		CAP,S 0.047-16
△ RY1	87-A91-281-010		RELAY,AC DC12V OSA-SS-212DM5	C796	87-010-403-080		CAP,ELECT 3.3-50V
△ S1	87-A90-234-010		SW,SL 1-2-2 SWS2201	C799	87-010-829-020		CAP,U 0.047-16
△ T1	87-A60-317-010		TERMINAL, 1P MSC	C812	87-012-286-020		CAP,U 0.01-25
△ T2	87-A60-317-010		TERMINAL, 1P MSC	C820	87-010-260-080		CAP,ELECT 47-25V
TUNER C.B				C821	87-012-286-020		CAP,U 0.01-25
C701	87-010-381-080		CAP,ELECT 330-16V	C822	87-012-286-020		CAP,U 0.01-25
C702	87-010-404-080		CAP,ELECT 4.7-50V	C823	87-012-286-020		CAP,U 0.01-25
C703	87-012-286-020		CAP,U 0.01-25	C828	87-010-196-020		CHIP CAPACITOR,0.1-25
C704	87-012-286-020		CAP,U 0.01-25	C829	87-010-196-020		CHIP CAPACITOR,0.1-25
C705	87-A10-592-020		C-CAP,S 0.015-50 J B	C959	87-010-196-020		CHIP CAPACITOR,0.1-25
C706	87-A10-592-020		C-CAP,S 0.015-50 J B	C960	87-010-196-020		CHIP CAPACITOR,0.1-25
C709	87-012-195-020		C-CAP,U 100P-50CH	C961	87-012-170-020		C-CAP,U 8P-50 D CH
C711	87-010-260-080		CAP,ELECT 47-25V	C963	87-010-196-020		CHIP CAPACITOR,0.1-25
C712	87-010-831-020		C-CAP,U,0.1-16F	CF801	87-008-261-010		FILTER,SFE10.7MA5
				CF802	87-008-261-010		FILTER,SFE10.7MA5
				CN701	87-A60-700-010		CONN,13P H GRY TUC-P13X-C1
				FFE801	A8-8ZA-190-030		8ZA-1 FEUNM
				J801	87-A60-702-010		TERMINAL,ANT 4P CJ-9036
				L771	87-A50-266-010		COIL,FM DET-2N(TOK)

REF.NO.	PART NO.	KANRI NO.	DESCRIPTION
L772	87-A91-110-010		FLTR,PCFJZH-450 (TOK)
L981	8Z-ZA1-667-010		COIL,AM PACK4F (TOK)
X721	87-A70-061-010		VIB,XTAL 4.500MHZ CSA-309

DECK C.B

CNA1	82-ZM1-636-010		CONN ASSY,9P
M1	87-045-347-010		MOT,SHU2L 70
SFR1	87-024-581-010		SFR,3.3K H KVSP637A
SOL2	82-ZM3-628-010		SOL ASSY,23SO
SW2	87-036-110-010		SW,MICRO SPPB62
SW3	87-036-110-010		SW,MICRO SPPB62
SW4	87-036-110-010		SW,MICRO SPPB62
SW5	87-036-110-010		SW,MICRO SPPB62
SW6	87-A90-248-010		SW,MICRO ESE11SH2CXQ
W1	82-ZM1-625-010		RBN-CORD,4P-5S

HEAD C.B

	85-ZM3-602-010		PWB,FLEX A
CN301	88-NF8-616-010		CONN ASSY,8P RPB

WIRING – 1 (TUNER)

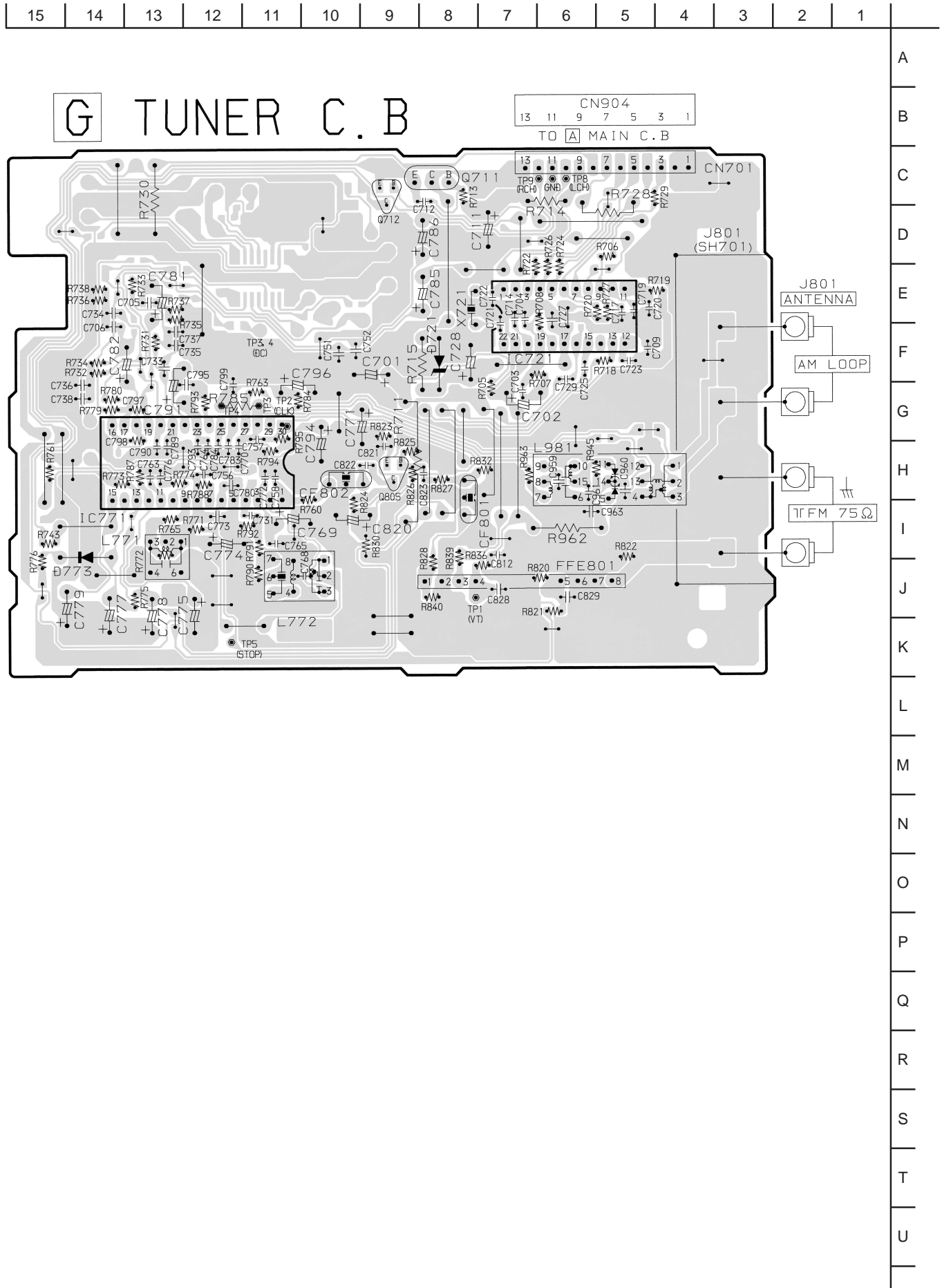

SCHEMATIC DIAGRAM (TUNER)

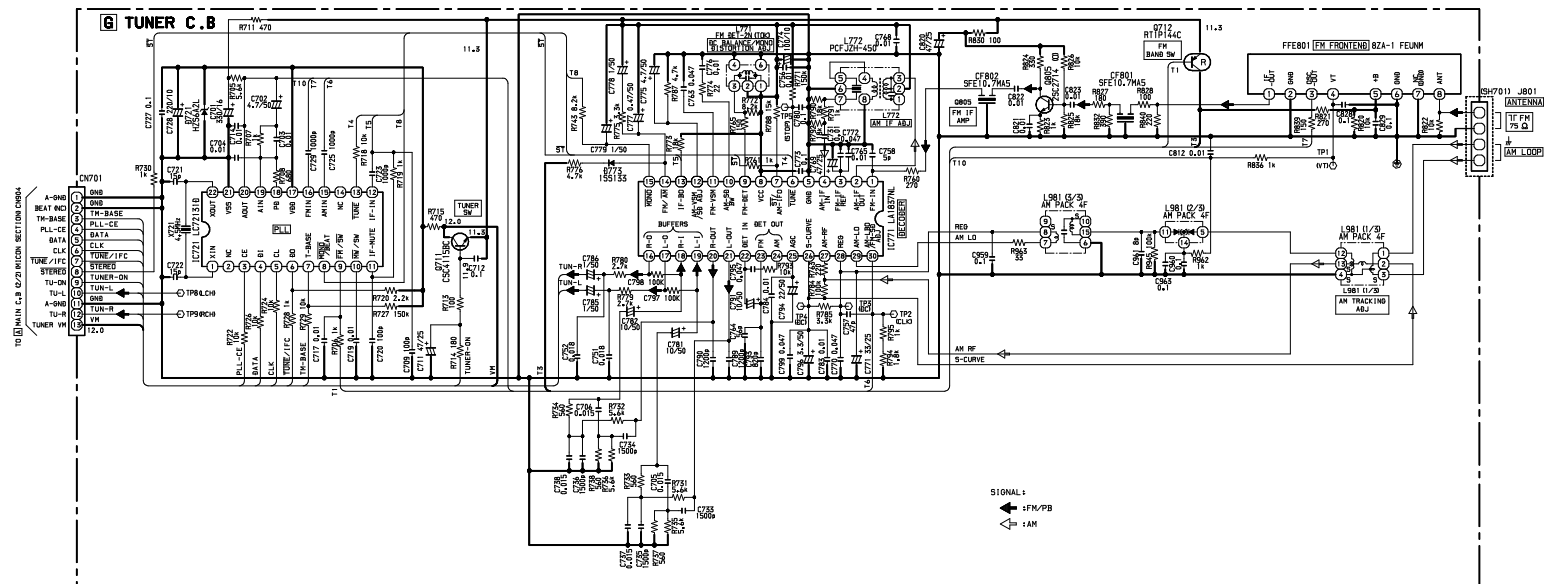

WIRING – 2 (DECK / HEAD)

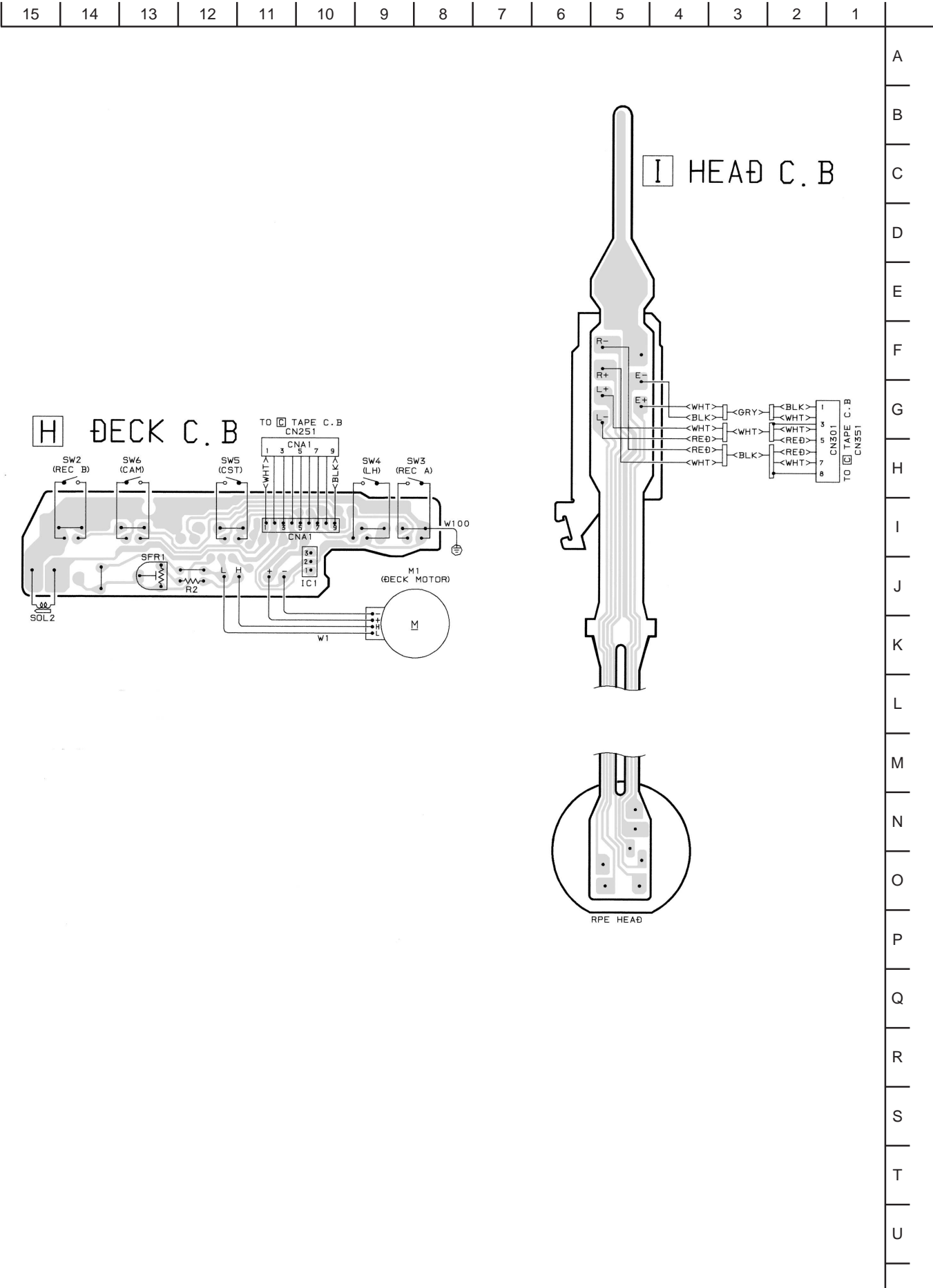

MECHANICAL EXPLODED VIEW 1 / 1

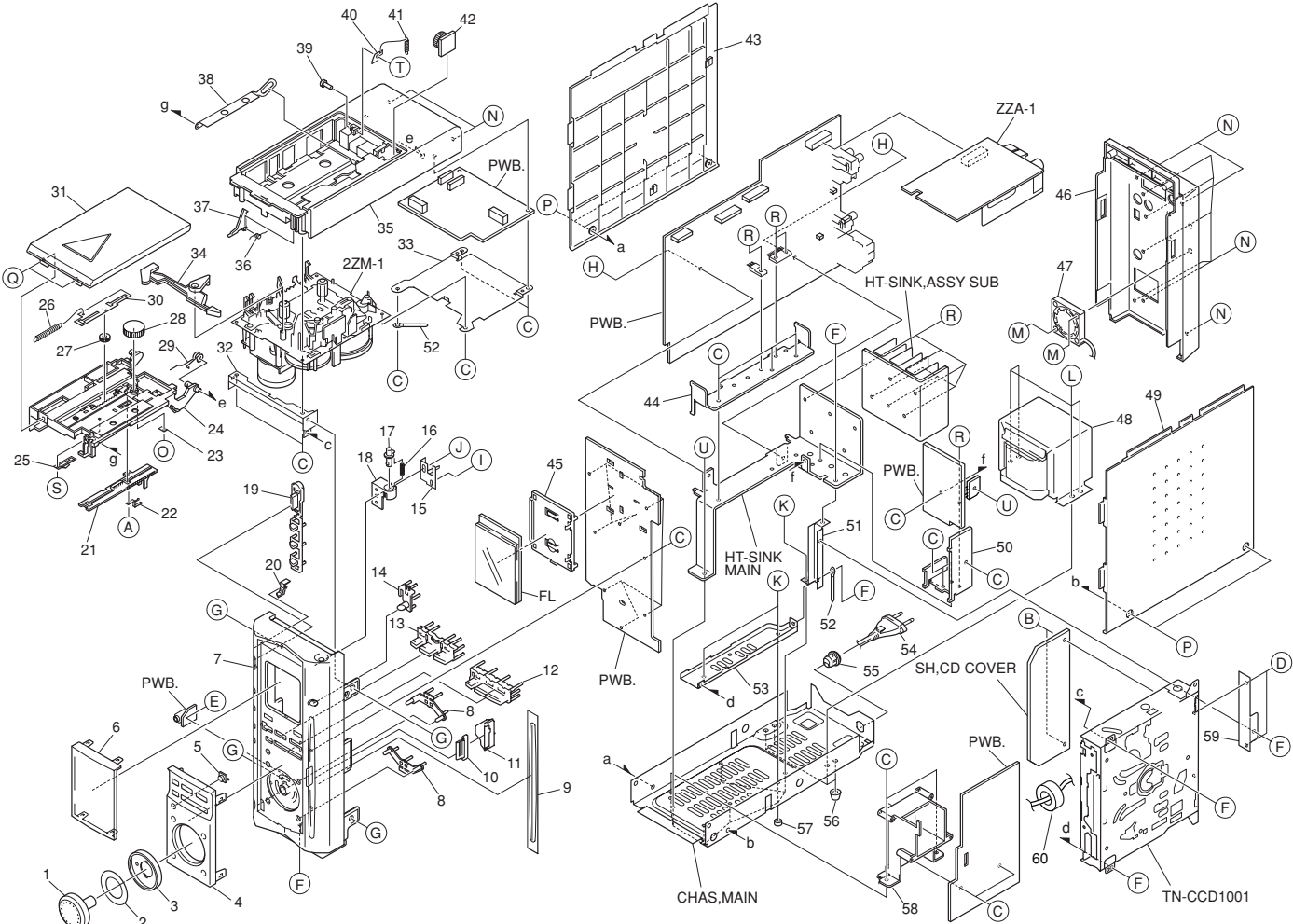

MECHANICAL PARTS LIST 1 / 1

REF. NO.	PART NO.	KANRI NO.	DESCRIPTION	REF. NO.	PART NO.	KANRI NO.	DESCRIPTION
1	8A-CJ5-016-010		KNOB, RTRY JOG	41	8A-CL5-325-010		SPR-C, TURN
2	8A-CJ5-217-010		PLATE, JOG	42	87-NF8-220-010		DMPR, 150
3	8A-CJ5-017-010		REFLECTOR, JOG	43	8A-CL5-044-110		PANEL, SIDE L(B)
4	8A-CL5-023-010		PANEL, FR CASS (B)	44	8A-CJ5-214-010		HLDR, TR
5	8A-CJ5-019-010		LENS, SENSOR	45	8A-CJ5-209-010		GUIDE, FL
6	8A-CJ5-007-010		WINDOW, DISPLAY	46	8A-CL5-048-010		CABI, REAR(B) H
7	8A-CL5-047-110		CABI, FR (B) H	47	8Z-CL1-663-010		FAN, MF40D-12-200MM
8	8A-CJ5-012-010		KEY, ENTER	48	8A-CJ5-624-010		PT, ACJ-5 HE
9	8A-CJ5-023-010		DUST COVER, CD FELT	49	8A-CL5-045-110		PANEL, SIDE R(B)
10	8A-CJ5-018-010		REFLECTOR, CD	50	8A-CL5-203-010		HLDR, DIODE
11	8A-CJ5-215-010		GUIDE, LED CD	51	8A-CJ5-206-010		HLDR, CD B
12	8A-CL5-025-010		KEY, SKIP CASS	52	87-064-185-010		HLDR, WIRE
13	8A-CL5-009-010		KEY, PLAY CASS	53	8A-CJ5-205-010		HLDR, CD A
14	8A-CJ5-013-010		KEY, EJECT CD	54	87-A80-092-010		AC CORD ASSY, E BLK SUN FAI
15	8A-CL5-305-110		PLATE, BOX LOCK	55	87-085-185-010		BUSHING, AC CORD (E)
16	8A-CL5-326-010		SPR-E, OPEN	56	8Z-NB8-240-010		COVER, PL
17	8A-CJ5-014-010		BTN, OPEN	57	8Z-CE3-206-010		CUSH, PL 9.2-4.2-5
18	8A-CL5-312-010		HLDR, BUTTON	58	8A-CJ5-204-010		HLDR, ECO
19	8A-CJ5-009-010		KEY, POWER	59	8A-CJ5-213-110		HLDR, MECHA CD
20	8A-CJ5-015-010		REFLECTOR, POWER	60	87-003-317-010		F-BEAD, F0H2515-LG7
21	8A-CL5-302-010		LEVER, POP-UP	A	87-265-544-310		V+2-2.2 NI
22	8A-CL5-323-010		SPR-P, LOCK	B	87-067-767-010		BVTT+2.6-6
23	8A-CL5-324-110		PLATE, LOCK	C	87-067-579-010		TAPPING SCREW, BVT2+3-8
24	8A-CL5-328-110		BOX, CASS (B)	D	87-067-421-010		VTT+2-4
25	8A-CL5-321-010		SPR-P, CAS PUSH R	E	88-AR1-217-010		S-SCREW, BFT2+3-8
26	8A-CL5-315-010		SPR-E, POP UP	F	87-067-688-010		BVTT+3-6
27	8A-CL5-301-010		GEAR, POP-UP2	G	87-591-094-410		TAPPING SCREW, QIT+3-6
28	8A-CL5-317-010		GEAR, DUMP	H	87-NF4-224-010		S-SCREW, IT3B+3-8 CU
29	8A-CL5-316-010		SPR-T, CASS	J	8A-CL5-327-010		S-SCREW, 2.6-11
30	8A-CL5-306-010		PLATE, ASSY POP-UP	K	87-067-584-010		TAPPING SCREW, BVT2+3-6
31	8A-CL5-024-010		LID, CASS (B)	L	87-078-191-010		S-SCREW, IT+4-10
32	8A-CL5-201-010		HLDR, FR	M	87-751-098-410		VT2+3-14 W/O SLOT
33	8A-CL5-202-010		HLDR, REAR	N	87-067-660-010		TAPPING SCREW, BVT2+3-8
34	8A-CL5-311-010		LEVER, EJECT	O	87-067-732-010		VT2+1.4-3 CR BLK HL
35	8A-CL5-042-110		CABI, TOP (B) EZ	P	87-067-641-010		UTT2+3-8 (W/O SLOT) BL
36	8A-CL5-313-110		SPR-T, BOX LOCK	Q	87-067-868-010		V+1.7-4 HL BLK
37	8A-CL5-308-210		LEVER, BOX LOCK	R	87-067-703-010		TAPPING SCREW, BVT2+3-10
38	8A-CL5-309-010		PLATE, GUIDE	S	87-351-547-310		VT2+2-3 BLK
39	8A-CL5-322-010		SHAFT, TURN	T	87-067-729-010		W-P, 1.3-4-0.25 C-OUT
40	8A-CL5-310-010		LEVER, TURN	U	87-067-579-010		TAPPING SCREW, BVT2+3-8

COLOR NAME TABLE

Basic color symbol	Color	Basic color symbol	Color	Basic color symbol	Color
B	Black	C	Cream	D	Orange
G	Green	H	Gray	L	Blue
LT	Transparent Blue	N	Gold	P	Pink
R	Red	S	Silver	ST	Titan Silver
T	Brown	V	Violet	W	White
WT	Transparent White	Y	Yellow	YT	Transparent Yellow
LM	Metallic Blue	LL	Light Blue	GT	Transparent Green
LD	Dark Blue	DT	Transparent Orange	GM	Metallic Green
YM	Metallic Yellow	DM	Metallic Orange	PT	Transparent Pink
LA	Aqua Blue				

TAPE MECHANISM EXPLODED VIEW 1 / 1

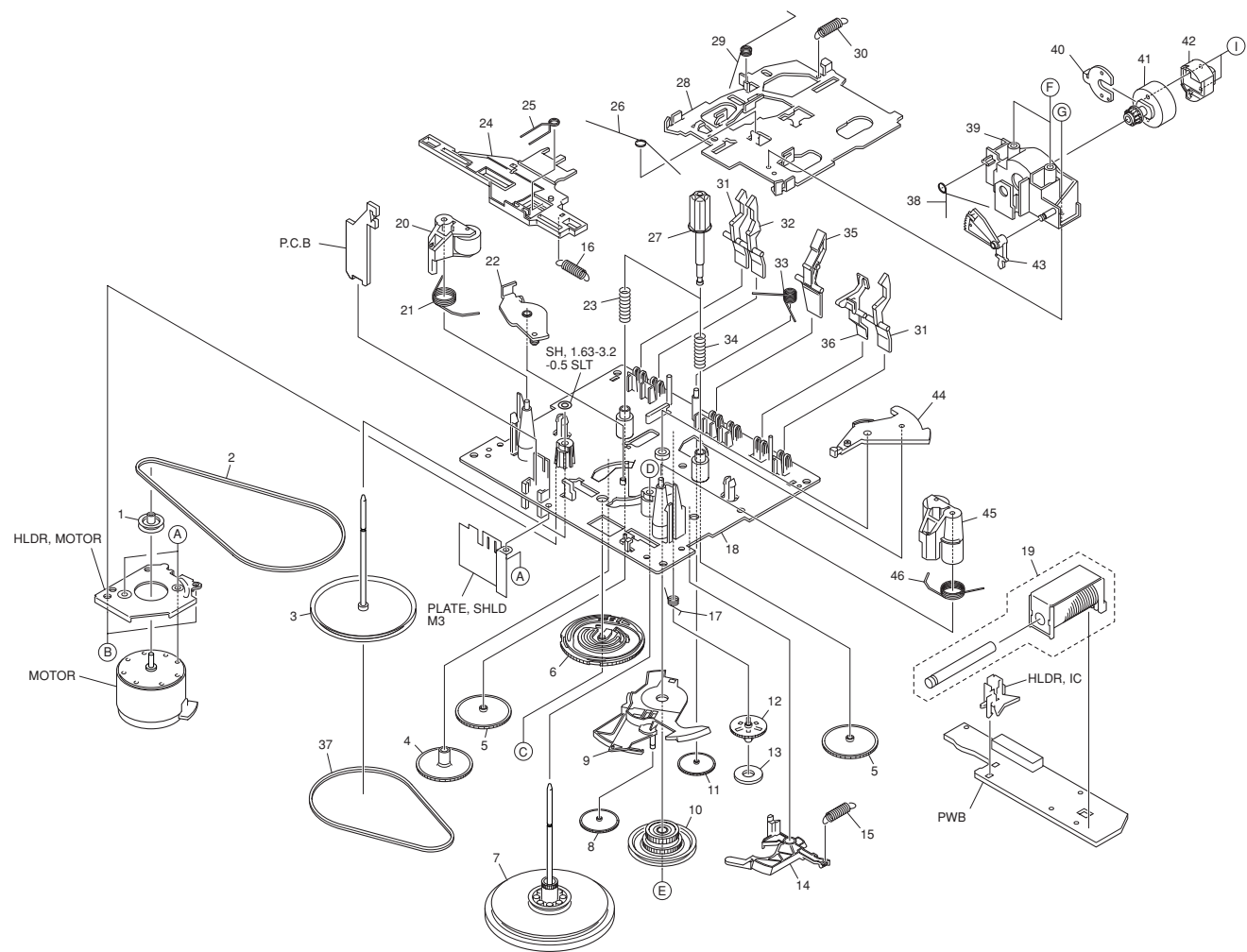

TAPE MECHANISM PARTS LIST 1 / 1

REF. NO.	PART NO.	KANRI NO.	DESCRIPTION	REF. NO.	PART NO.	KANRI NO.	DESCRIPTION
1	82-ZM1-247-210		PULLEY, MOTOR	31	82-ZM1-240-110		LVR, REC (*)
2	82-ZM1-354-010		BELT, SBU MAIN2 EPDM	32	82-ZM1-241-310		LVR, MC
3	82-ZM1-234-310		FLY-WHL ASSY, L	33	82-ZM1-257-010		SPR-T, CAS
4	82-ZM1-226-010		GEAR, REW	34	82-ZM1-285-410		SPR-C, BT L
5	82-ZM1-216-510		GEAR, REEL	35	82-ZM1-242-010		LVR, CAS
6	82-ZM1-221-310		GEAR, CAM (*)	36	82-ZM1-243-010		LVR, STOP
7	82-ZM1-237-610		FLY-WHL ASSY, R	37	82-ZM1-338-110		BELT, FR 4
8	82-ZM1-225-210		GEAR, FR	38	82-ZM3-353-010		SPR-T, HEAD 2
9	82-ZM1-224-410		LVR, FR	39	82-ZM1-207-910		GUIDE, TAPE
10	82-ZM3-333-310		SLIP DISK ASSY 2	40	82-ZM1-314-110		PLATE, HEAD
11	82-ZM1-223-010		GEAR, PLAY	41	82-ZM1-208-310		HLDR, HEAD
12	82-ZM1-220-210		GEAR, IDLER	42	87-A90-821-010		HEAD, RPH HADKH56 FPC
13	82-ZM3-616-010		RING MAGNET 4	43	82-ZM1-210-110		GEAR, H T
14	82-ZM1-227-310		LVR, TRIG	44	82-ZM1-222-310		LVR, PLAY (*)
15	82-ZM1-305-210		SPR-E, TRIG 2	45	82-ZM1-344-210		LVR ASSY, PINCH R2
16	82-ZM1-255-310		SPR-E, LVR DIR	46	82-ZM1-259-210		SPR-T, PINCH R
17	82-ZM1-322-010		SPR-T, FR 60	A	87-251-070-410		U+2.6-3
18	82-ZM1-358-010		CHAS ASSY, FPC	B	87-741-073-410		UT2+2.6-6 GLD
19	82-ZM3-628-010		SOL ASSY, 23 SO	C	87-B10-008-010		W-P, 2.08-8-0.4-SLIP
20	82-ZM1-341-210		LVR ASSY, PINCH L2	D	80-ZM6-243-010		SH 1.75-3.6-0.5 SLT
21	82-ZM1-258-210		SPR-T, PINCH L	E	82-ZM3-334-010		PW 2.16-6-0.4
22	82-ZM1-333-210		PLATE, LINK2	F	86-ZM4-206-110		S-SCREW, AZIMUTH L
23	82-ZM1-244-510		SPR-C, BT	G	85-ZM3-202-010		S-SCREW, TG
24	82-ZM1-266-310		LVR, DIR	H	82-ZM3-222-010		S-SCREW, SHILD PLATE
25	82-ZM1-214-010		SPR-T, DIR	I	80-ZM6-207-010		V+1.6-7
26	82-ZM1-269-210		SPR-T, BRG				
27	82-ZM1-217-410		REEL TABLE				
28	82-ZM1-206-910		CHAS, HEAD				
29	82-ZM1-219-110		SPR-T, LINK				
30	82-ZM1-218-010		SPR-E, HB				

SPEAKER PARTS LIST < SX-M7 >

REF. NO.	PART NO.	KANRI NO.	DESCRIPTION
1	8A-CL5-404-010		GRILLE, FRAME ASSY
2	8A-CJ5-415-010		TERMINAL
3	8A-CL5-408-010		PANEL, SP B
4	8A-CJ5-417-010		SPKR, TW 25
5	8A-CL5-406-010		SPKR, W 87S1
6	8A-CL5-403-010		PANEL, FR B
7	8Z-CL5-543-010		CORD, SP

ACCESSORIES / PACKAGE LIST

REF. NO.	PART NO.	KANRI NO.	DESCRIPTION
1	87-CL5-901-010		IB, H(ECA)M
2	8A-CL5-954-010		RC UNIT, RC-ATT03 (B)
3	87-006-225-010		ANT, LOOP ANT NC2
4	87-043-115-010		FEEDER-ANT, FM
△ 5	87-A91-017-010		PLUG, CONVERSION JT-0476



アイワ株式会社 〒110-8710 東京都台東区池之端1-2-11 ☎03(3827)3111 (代表)
AIWA CO.,LTD. 2-11, IKENOHATA 1-CHOME, TAITO-KU, TOKYO 110, JAPAN TEL:03 (3827) 3111